

Feed-Thru Boot Assemblies for Coaxial Cable Applications

1188 IB B

PRODUCT DESCRIPTION

Feed-Thru Boot Assemblies have a one-piece design freeing an installer's hands in order to position and insert the coax runs, and tighten the round member adaptor clamps without having to hold two separate pieces of boot in place. Boot assemblies are designed to be fitted onto EP series entry panels in wall-roof feed-through applications. The durable boot is unaffected by ozone, sunlight, aging, or hot and cold extremities, and is designed to meet ASTM-1200 and ASE I2000 specifications. Each boot assembly includes the boot and two round member adaptor clamps. Boot Assemblies may be ordered with or without cushion inserts.

NOTICE

Installation of this product should only be performed by trained, qualified and experienced personnel. Installation instructions for this product should be read thoroughly before installation is performed. The manufacturer and supplier of this product disclaims any liability or responsibility for the results of improper or unsafe installation practice.

MATERIAL LIST

- 4" Feed-Thru Boot Assembly
 - (1) 4" Boot
 - (1) #80 Hose Clamp
 - (1) #64 Hose Clamp
 - (1) Cushion Insert*
- 5" Feed-Thru Boot Assembly
 - (1) 5" Boot
 - (1) #88 Hose Clamp
 - (1) #64 Hose Clamp
 - (1) Cushion Insert*

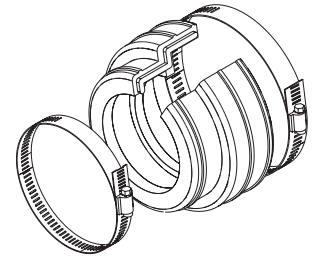

*Cushion Inserts available in specified models.

REQUIRED TOOLS

- (1) 5/16" Nut Driver
- (1) Flathead Screwdriver

TYPICAL APPLICATIONS

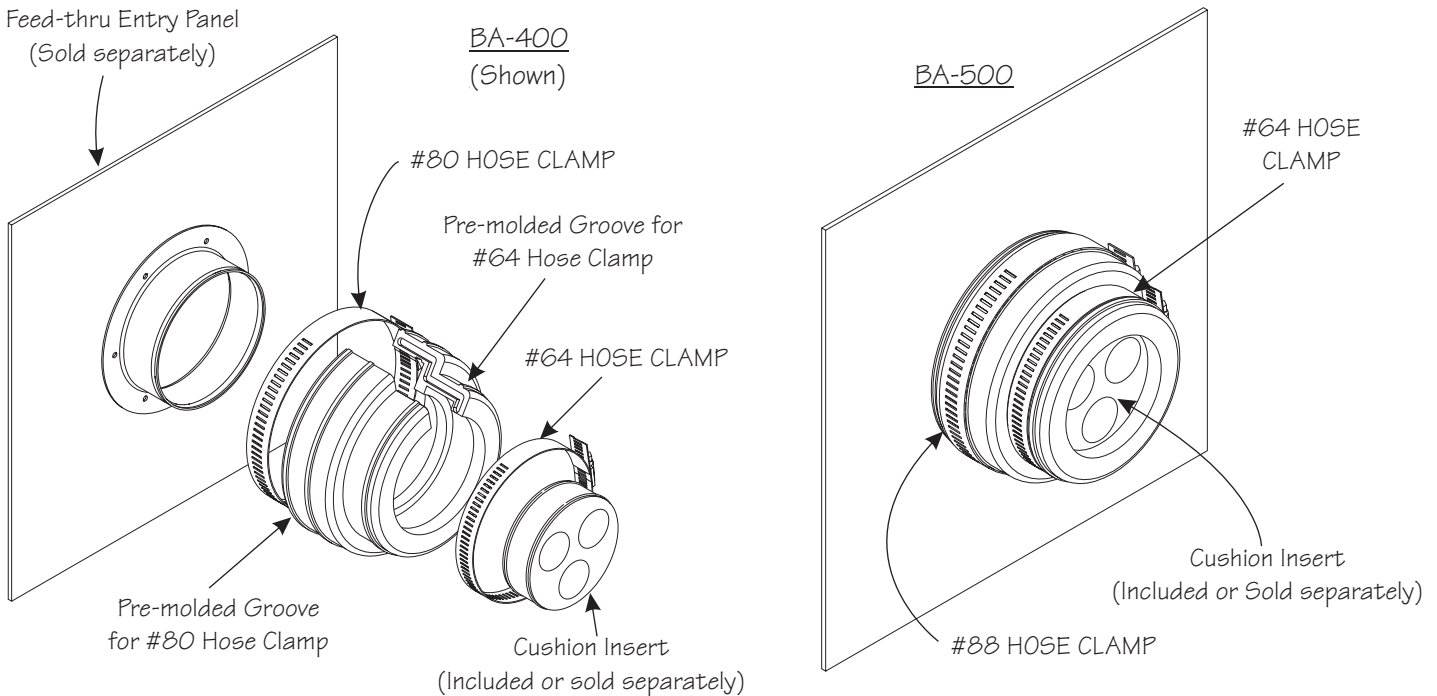

ADDITIONAL MOUNTING ACCESSORIES

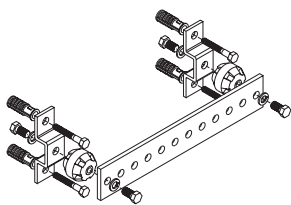

Ground Bus Bars Kits

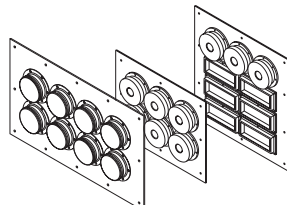

Entry Port Systems

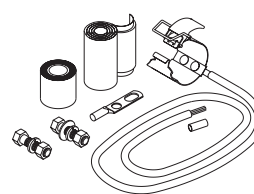

Clip-on
Ground Kit

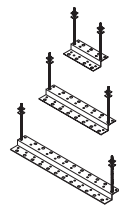

Trapeze kits