

EMP / Lightning Protector – Gas Capsule

Part # 176210

Features

- Replaceable Gas Capsules
- Very competitively priced
- Bulk Head Design for Panel Mounting
- Weather proof “O” Ring Seal to panel and capsule cover
- Broadband use for most applications DC-2.5 GHz
- Suitable for RF Power Systems upto 600w
- Supplied with Earthing lug and Mounting bracket
- Premium Quality Plating Throughout, Cu-Sn-Zn Outer Silver inner conductor
- Various Gas Voltage Capsule available depending on system RF Power.



Voltage Protection V=	Frequency Range VSWR	Capsule Protector
		Benelec #
90V	$0 \leq f \leq 1 \text{ GHz}$ ≤ 1.06	176901
230V		176902
350V	$0 \leq f \leq 2.5 \text{ GHz}$ ≤ 1.2	176903

Fixed adaptor, female – female Bulk Head, with EMP protector (gas filled)

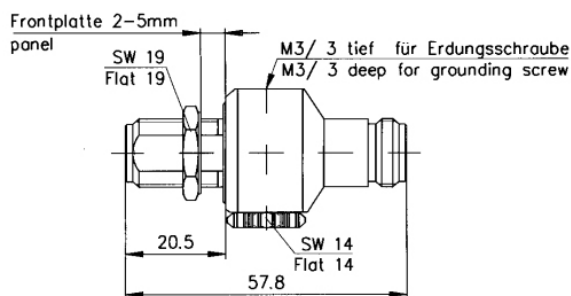
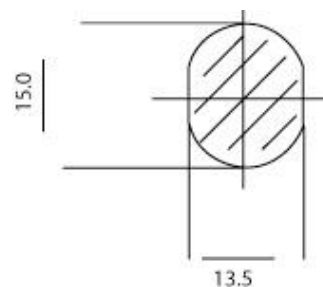

Fig.1

Gas Capsule



Panel Entry Hole



Gas Capsule Selection Chart

Maximum RF Power (CW) Vs System VSWR

Gas Capsule, Spark Over Voltage	1.00 : 1	1.22 : 1	1.5 : 1	3.00 : 1
90 V	28 W	22 W	20 W	12 W
230 V	180 W	150 W	110 W	80 W
350 V	500w	430w	320w	250w

It is important to match the correct Spark over voltage to the power rating of the RF system, this will ensure maximum protection to your transmission equipment. If you require any help with the selection please contact our sales staff at Benelec. You should also be aware that the gas capsule will deteriorate with the level of strikes received. If the system performance noticeable deteriorates then one or more strikes have occurred and the capsule needs to be replaced.

Capsules are relatively low cost hence it is recommended that spares should be kept on site for quick change over and minimum down time.